

# Futaba T14SG Software Update Changes (Version 2.0)

This software update modifies features found on the 14SG. If you have questions about these updated directions, please consult your instruction manual or futaba-rc.com for further details. Refer to the original manual where applicable but replace the steps indicated below with these instructions.

## 1. TELEMETRY MONITOR

The telemetry screen is modified.

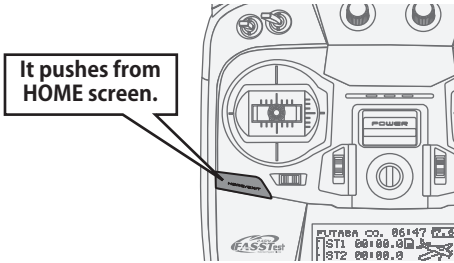

To TELEMETRY MONITOR

You can display any items on the telemetry screen up to 4 items at FASSTest 14CH mode. The benefit of expansion of a character will be obtained by choosing the display items 1 and 2.

### Ex. 1 item is displayed



If the numeric part (included "+", "-", ",", ".") is over the 6 letters, it becomes the smaller size automatically. It is same size as 2 items screen.

### Ex. 2 items are displayed

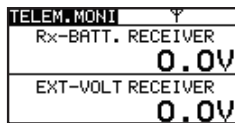

In FASSTest12CH mode, they are only 1 and 2 item displays.

### Ex. 3 items are displayed

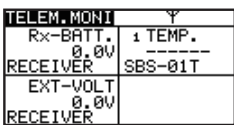

### Ex. 4 items are displayed

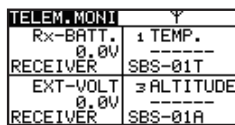

## ● TELEMETRY MONITOR set up

- ① The **HOME/EXIT** button is pushed from HOME screen and **TELEMETRY MONITOR** is called.

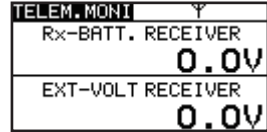

- ② Move the cursor to the "RECEIVER" or "SENSOR" (SBS-XXX etc.) and touch the RTN button.

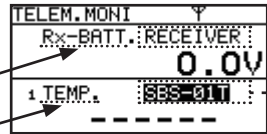

If a cursor is moved to items (**Rx-BATT**, **EXT-VOL**, **TEMP.** etc.) and RTN is touched, the alarm setting screen of the item will be displayed.

- ③ You will use the "Display" function to choose how many sensors are shown on your Telemetry monitor.

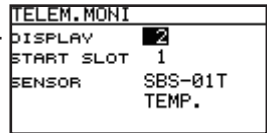

## [ Display position ]

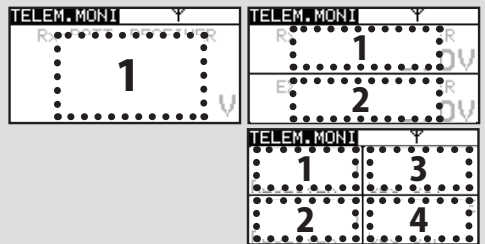

The Telemetry Monitor is accessed by a quick tap of the **HOME/EXIT** key. Do not press and hold as this will activate Key Lock.



Lock or unlock is done either by pressing and holding the **S1** key or by pressing and holding the **HOME/EXIT** key.

- ④ If you want to show two sensors on your Telemetry screen, select 2 in "Display". Then move down to the Sensor to select which other item is shown.

```

TELEM. MONI
DISPLAY      2
START SLOT  3
SENSOR      SBS-01A
            ALTITUDE
  
```

When using a sensor that has two or more functions, you will want to scroll to select which will be displayed. (**ALTITUDE,VARIO, etc.**)

- ⑤ If you want to show three sensors on your Telemetry screen, select 3 in "Display". Then move down to the Sensor to select which other item is shown.

- ⑥ To SENSOR "-----" selection will reduce a display item.

```

Are you sure?
DISPLAY      3
START SLOT  --
SENSOR      -----
  
```

## 2. Telemetry Speech function

- There is not only a software update, but also a Speech update that must be done.
- There are two languages available in the Speech data, English and German.
- The language chosen for the Speech data will affect only the Speech function. It will not change the language used in the transmitter's text display.
- The Speech function can only be used with headphones plugged into the phone jack.
- You will need to purchase headphones or earphones with a 3.5plug.

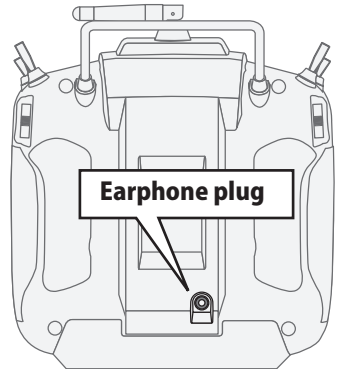

- **TELEM.SET. menu is added to the LINKAGE MENU.**

```

LINKAGE MENU 2/2
THR CUT      : TELEMTRY
IDLE DOWN    : SENSOR
T1-T4 SET.   : DATA RESET
WARNING
TELEM.SET. :
  
```

The speech language installed is indicated. When the speech data is not installed, "-----" is displayed.

The version No. of the speech data file is indicated. When the speech data is not installed, nothing is displayed.

```

TELEM.SET.
SPEECH       JAPANESE
VERSION      Ver. 1
INTERVAL     0 SEC
  
```

The interval of speech can be set. The setting range is from 0 [Sec] to 30 [Sec].

● The phone volume is added to SOUND menu in SYSTEM MENU.

SOUND	
TIMER	ON
WARNING	ON
TELEMETRY	ON
OTHER SOUND	ON
PHONE VOLUME	30

The setting range is from 0 to 30.  
0 is silence.

● ACT/INH button and ON/OFF switch button of the speech function are added to the telemetry alert screen.

ALTI TITUDE		2/2
↑ALERT	INH	
↓THRESHOLD	-50	m
↑Vibes	OFF	
SPEECH	ACT	SA on
REFERENCE	SET	

When the speech function is valid, "on" is displayed.  
When the speech function is INH or the switch is off, nothing is displayed.  
The speech function does not work when the telemetry data is not received, even if "on" is displayed.

\*The format of the speech output is  
[sensor type] [data] [unit] [data] [data] [data] [data]  
Ex. Rx battery  
「battery」 「seven point four」 「volt」 「seven point four」 「seven point four」 「seven point four」 「seven point four」  
\*If the telemetry data is changed frequently, the speech data will not be the same as the displayed data.

● When the telemetry alert occurred, the speech function works.

ALTI TITUDE		1/2
< MIN/MAX > -----		
-----		
↑ALERT	ACT	
↓THRESHOLD	+200	m
↑Vibes	OFF	

When the ALERT button is ACT, the speech function works when the alert occurs.

ALTI TITUDE		2/2
↑ALERT	ACT	
↓THRESHOLD	-50	m
↑Vibes	OFF	
SPEECH	ACT	SA on
REFERENCE	SET	

\*The format of the speech output is  
"warning" [sensor type] [data] [unit]  
Ex. Rx battery  
「warning」 「battery」 「four point zero」 「volt」  
\*If the telemetry data is changed frequently, the speech data will not be the same as the displayed data.

● The vario melody outputs from the phone jack.

When the melody function is active, the vario melody outputs from the phone jack.

VARIO		2/2
↑ALERT	INH	
↓THRESHOLD	+0	m/s
↑Vibes	OFF	
SPEECH	INH	
MELODY	ACT	SA on

The priority of the phone output is below;  
Speaking Alarm >> Speaking data >> Vario Melody  
(High priority) (Low priority)

3. The setting range of the threshold of temperature sensors is modified.

TEMP.		1/2
< MIN/MAX > -----		
-----		
↑ALERT	INH	
↓THRESHOLD	+100	°C
↑Vibes	OFF	

-19 °C ~ 200 °C ( ↑ THRESHOLD >  
↓ THRESHOLD)  
at both of SBS-01T and Temp125

TEMP.		2/2
↑ALERT	INH	
↓THRESHOLD	+0	°C
↑Vibes	OFF	
SPEECH	INH	

-20 °C ~ 199 °C ( ↑ THRESHOLD >  
↓ THRESHOLD)  
at both of SBS-01T and Temp125

---

©Copyright 2013. No part of this manual may be reproduced in any form without prior permission. The contents of this manual are subject to change without prior notice. While this manual has been carefully written, there may be inadvertent errors or omissions. Please contact our service center if you feel that any corrections or clarifications should be made.

FUTABA CORPORATION Phone: +81 475 32 6982, Facsimile: +81 475 32 6983  
1080 Yabutsuka, Chosei-mura, Chosei-gun, Chiba 299-4395, Japan

©FUTABA CORPORATION 2013, 8 (1)