

Your Futaba FX-32/FMT-01 transmitter programming can be updated easily online. When functions are added or improved, the update file can be downloaded from our website. Copy the update files to the SD card and then use the following procedure to update the program.

Check our web site for the FAQ regarding updating for more information.

### [Updating procedure]

**Note:** If the battery fully discharges during program updating, updating will fail. When the remaining battery capacity is 50% or less, always recharge the battery before updating.

**Note:** The model data in the transmitter can be used unchanged after updating, but to be safe, back up the model data before updating.

1. Download the zip file of the update data from our website.

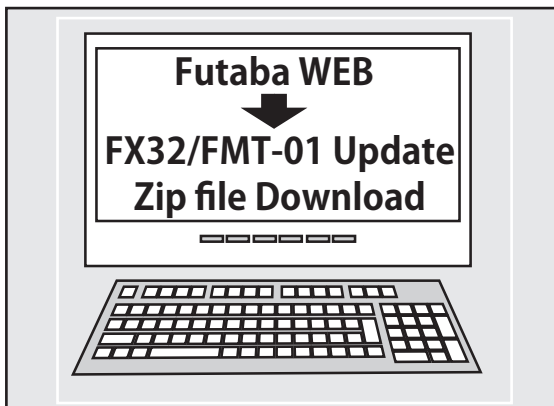

2. Extract the zip file on your computer.
3. The "FUTABA" folder will be created on your computer.
4. Copy the "FUTABA" folder into your SD card.

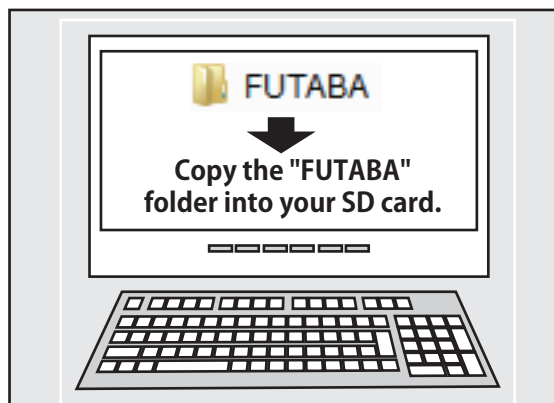

**Note:** If the SD card has already had "another FUTABA" folder before you make a copy, the "FUTABA" folder is OVERWRITTEN.

5. Insert the SD card with "FUTABA" folder that contained the update software into the SD card slot on your transmitter.

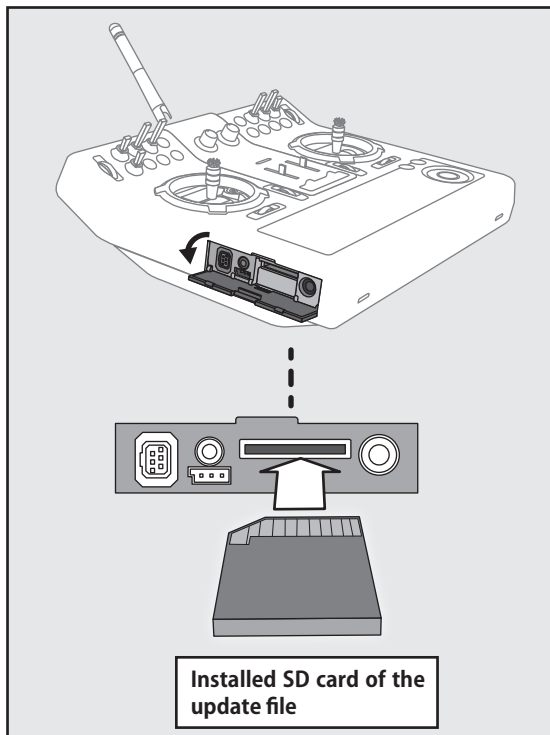

6. Turn on the transmitter power while pressing down the "Home/Exit" button. The update screen appears on the LCD display of your transmitter and the software update is started.

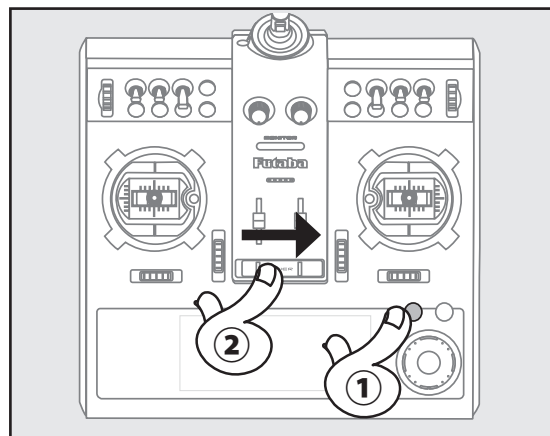

**Press the Home/Exit button and turn ON**

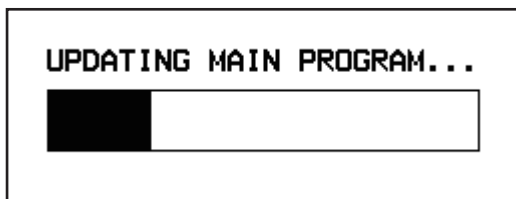

Updating

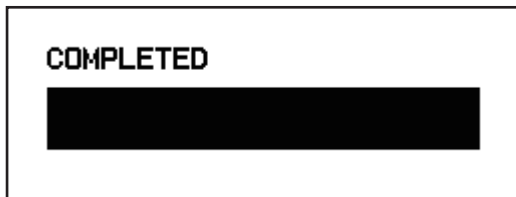

Complete



**Don't absolutely remove the battery and the SD card from the transmitter during the update.**

There is a possibility that the transmitter will be damaged.

7. When the software update is completed, "Completed" message is shown on the LCD display of your transmitter.
8. Turn off the power switch of your transmitter and remove the SD card from the card slot.

### **Possible Problems**

When one of the error messages shown below appears on the LCD screen your transmitter, the software update will not be completed.

#### **"Low battery."**

Software update is postponed because of low battery. Retry the software update after the battery is recharged.

#### **"Update file not found."**

The transmitter cannot find the update file on the SD card. Check to be sure all the update files have been copied onto the SD card.

#### **"Broken file."**

The transmitter detects the update file error. The update file may be broken or for another transmitter.

#### **"Write error."**

The software update procedure is stopped for an unknown reason. Contact your local service center when this error message appears on the LCD screen of your transmitter.

# Futaba® FX-32/FMT-01 SOFTWARE UPDATE CHANGES

1M23Z04701

## V1.7

This software updates or alters the functions and features noted below. The instructions and information that follow are meant as a supplement to the original instruction manual that accompanied the FX-32/FMT-01 transmitter. Please refer to the original instruction manual where applicable, but replace the steps indicated below with these instructions. Please check to ensure that the update has been installed.

- 1) Select the System Menu.
- 2) Touch the [Information] button.
- 3) Confirm that the information in the display indicates the version numbers as noted above.

### 1. SBS-01S S.BUS servo sensor function

\*SBS-01S must be installed in the aircraft.

The FX-32/FMT-01 has been made compatible with the SBS-01S S.BUS servo sensor. The SBS-01S can monitor and display the in-flight current, operating angle, and internal temperature of up to two S.BUS2 servos.

If you forget to connect the servo wiring during fuselage assembly, or the servo was disconnected, an alarm can be activated at the transmitter.



#### ◆ SBS-01S is registered with a transmitter.

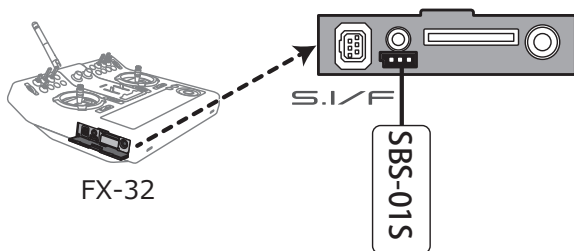

- ① Connect the sensor to the FX-32/FMT-01 as shown in the figure above.
- ② [Linkage menu] → [Sensor] → [Page 3/3] is opened from the FX-32/FMT-01.
- ③ Tap [Register]
- ④ Complete registration and remove SBS-01S from the transmitter.

#### ◆ Calling of a servo sensor screen.

- ① [Linkage menu] → [Telemetry]

- ② Select [SERVO SENS.] in the TELEMETRY screen and access the next screen shown below by touching the RTN button.

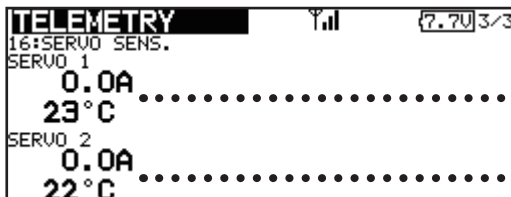

The temperature and the angle of servo 1

The temperature and the angle of servo 2

#### ◆ Servo sensor screen

To current setup screen

To temperature setup screen

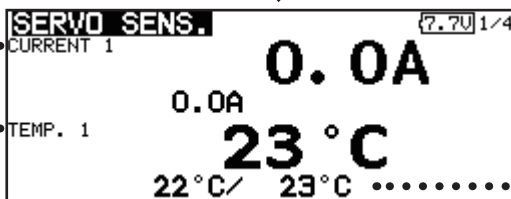

Page

1/4 : Servo1: Current • Temp

2/4 : Servo1: Angle

Servo2: Current

3/4 : Servo2: Temp • Angle

4/4 : Servo1 • 2 : Connect

Max. and min. values since the power was turned ON will display.

## ◆ Alarm setting

↑ An upward arrow indicates the alarm will sound when the current reaches above your set value.

↓ A downward arrow indicates the alarm will sound when the current reaches below your set value.

The ON/OFF switch of Speech is chosen.

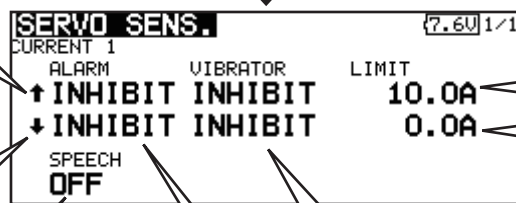

A setup of the current on which the alarm operates.

Alarm is chosen from Buzzer, Voice, and Inhibit.

### "Vibrator" type

If the following types are selected, the transmitter will vibrate during the warning.

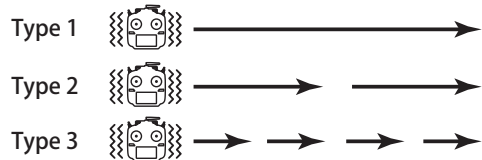

## ◆ Alarm setting

If you forget to connect the servo wiring during fuselage assembly, or the servo was disconnected, an alarm can be activated at the transmitter.

When the Alarm or Vibrator options are activated, the servo connection will display.

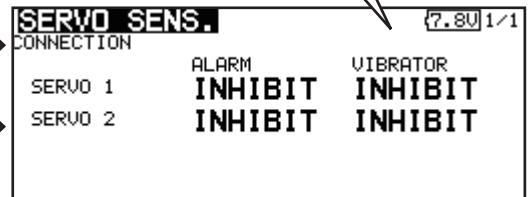
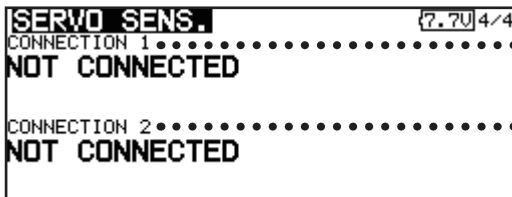

\*This alarm and display is limited to the S.BUS servos connected to the servo sensors.

## 2. SBS-01C current sensor function

The FX-32/FMT-01 has been made compatible with the SBS-01C current sensor. The SBS-01C has the capability of measuring current, voltage and capacity (consumption) from drive battery at the same time.

\*Current sensor must be installed in the aircraft.

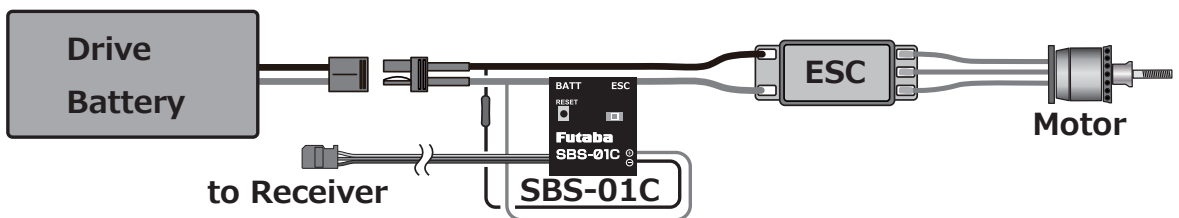

## ◆ SBS-01C is registered with a transmitter.

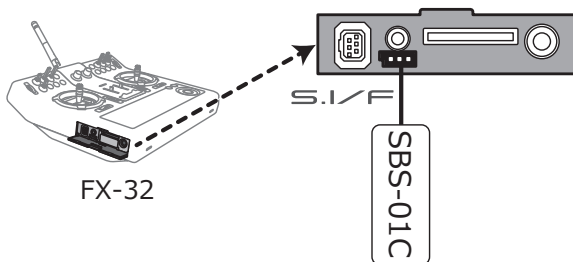

- ① Connect the sensor to the FX-32/FMT-01 as shown in the figure above.
- ② [Linkage menu] → [Sensor] → [Page 3/3] is opened from the FX-32/FMT-01.
- ③ Tap [Register]
- ④ Complete registration and remove SBS-01C from the transmitter.

◆ Calling of a current sensor screen.

① [Linkage menu] → [Telemetry]

② Tap [Current]

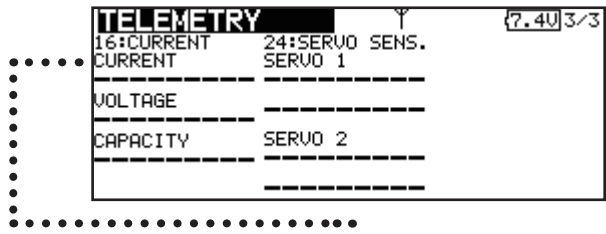

◆ Current sensor screen

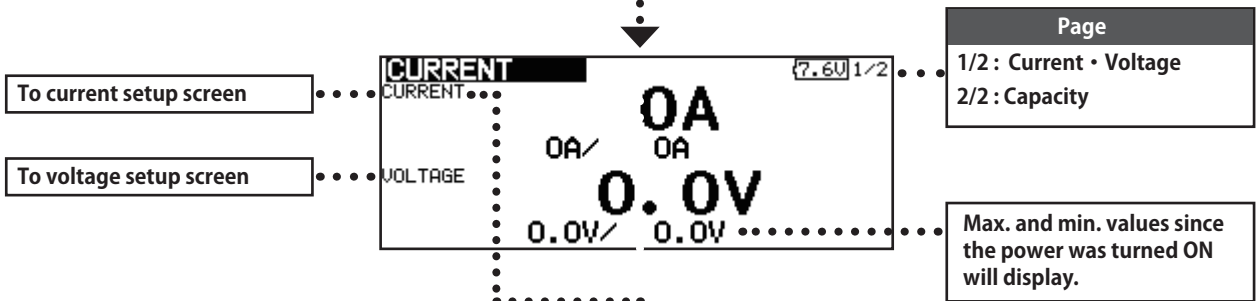

◆ Alarm setting

